

INSTRUCTIONS

1. Please count and make sure all pieces are present before assembly.
2. The pole pieces are delicate. To prevent damage, do not use excessive force.
3. Assemble crystal puzzle by putting the puzzle pieces together in the order shown below.
4. Missing a piece? Email info@ugames.com or call (415) 503-1600 with missing piece number.

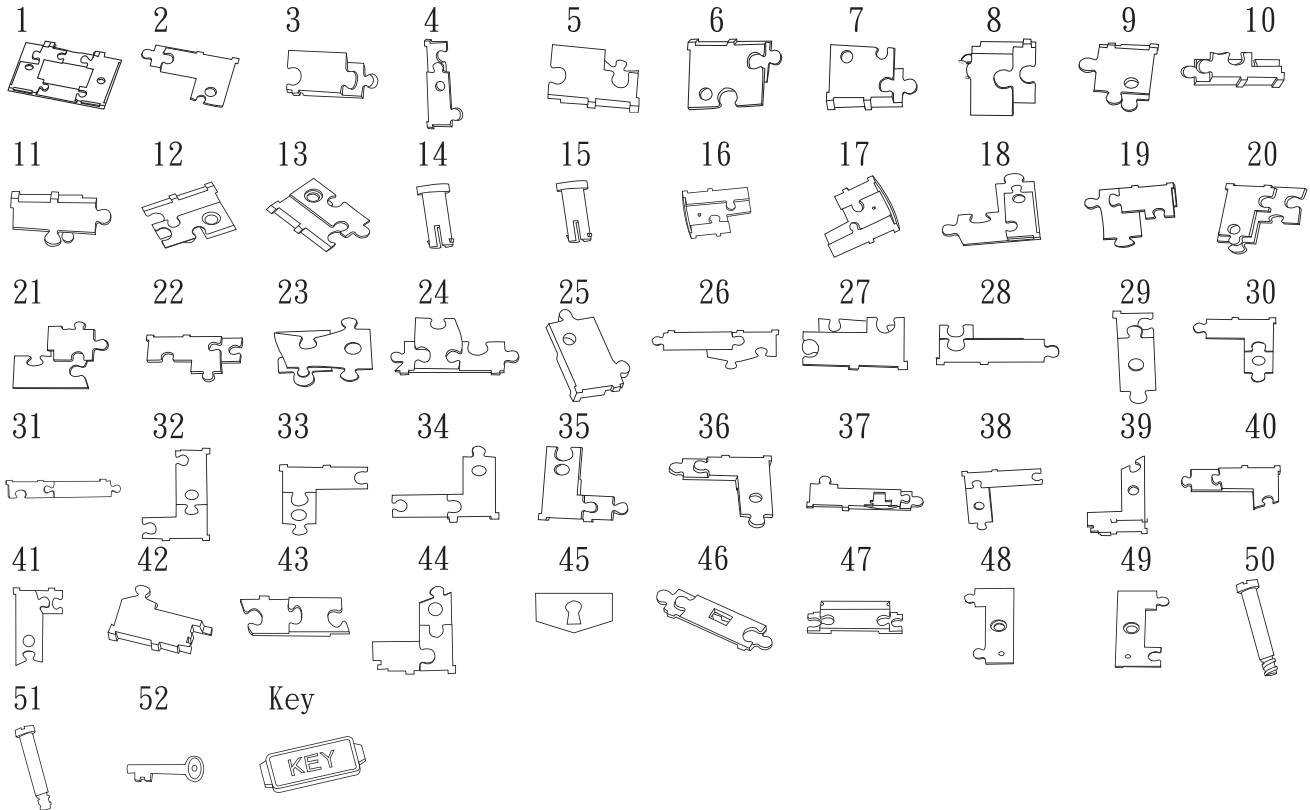

HINTS

1

Don't lose any of the puzzle pieces.

2

Complete the Top cover first then insert the poles from the bottom of the cover. Attach the top 2 pieces, #16 & 17, to the pole until you hear a "click" sound to lock the puzzle pieces.

3

Complete the bottom and insert the poles from top to bottom until you hear a "click" sound to lock the puzzle pieces. Attach the cover.

4

Close the top and open it with the enclosed key.

