

**INSTRUCTIONS**

1. Please count and make sure all pieces are present before assembly.
2. The pole pieces are delicate. To prevent damage, do not use excessive force.
3. Assemble crystal puzzle by putting the puzzle pieces together in the order shown below.
4. Missing a piece? Email [info@ugames.com](mailto:info@ugames.com) or call (415) 503-1600 with missing piece number.

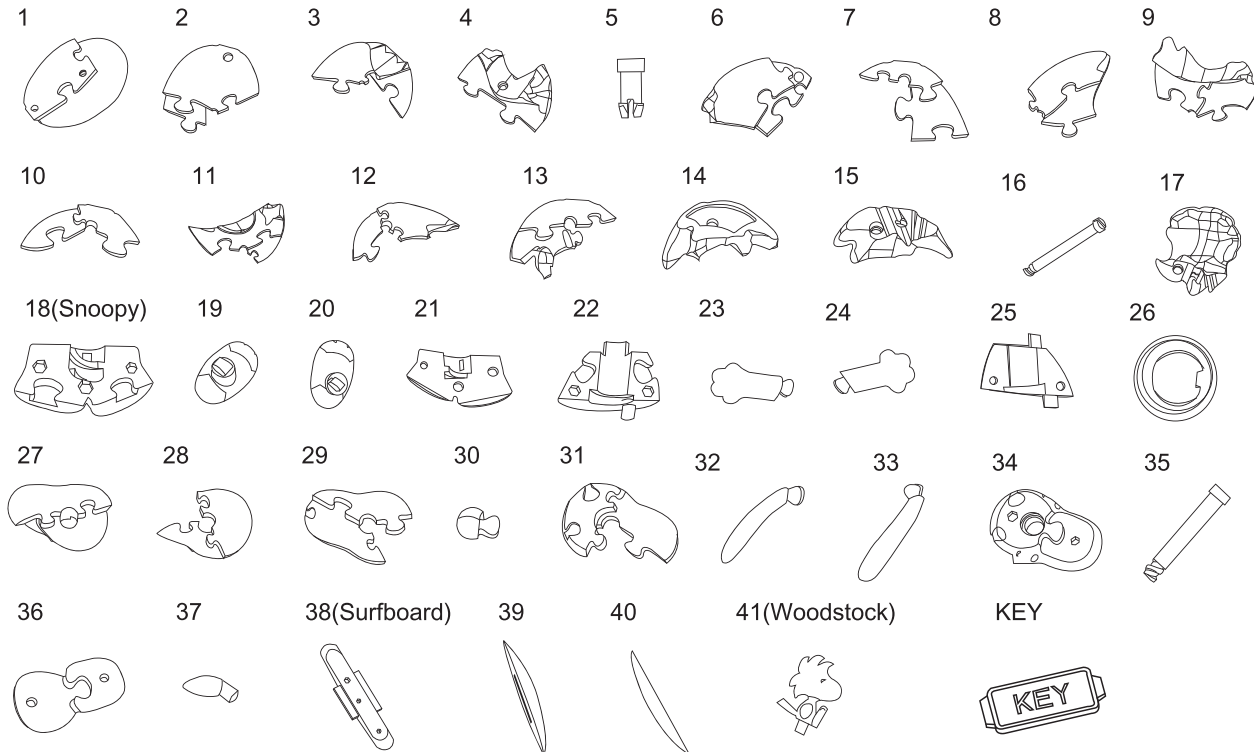

**HINTS**

**1**

Don't lose any of the puzzle pieces.

**2**

Attach Snoopy & Woodstock to the surfboard, then mount the surfboard to the wave.

**3**

Build Snoopy's head and insert onto the body, then secure with the center pole.

**4**

After inserting the center pole, use the key and turn clockwise to secure all pieces.

